



WF Cartridge filter housing in plastic

1 - 300 micron / 0,75 - 3 m³/h

WF Cartridge Filters from HiFlux are used where there is a need for reliable and precise fine filtration from 1 microns with a large dirt capacity in operating environment where steel filters are not appropriate or where the processes prescribe the use of plastic materials. The filter housings are designed for 8,6 bar working pressure, and they are equipped with a simple and secure closing system which makes it quick to change filter cartridges, thereby maximizing the time the filters are in operation.

A compact design ensures the best possible flow and consequently a small differential pressure, long intervals between cartridge changes and lower energy consumption.

The filter housing is designed with a bursting pressure of 35 bar and ageing parameters exceeding 100,000 cycles from 0 to 10.5 bar.

The maximum working temperature is 40 °C at 8.6 bar.

The filter housing tops are made of polypropylene and the bottom bowl of either white polypropylene or the transparent plastic type SAN. Models 122 and 202 are equipped with pressure equalisation valve/air vent.

Model 120 has an integrated bypass valve/block valve which means that the stopping process can be avoided when changing the filter cartridge. The building in of block valves before and after the filter housing is also avoided. Automatic venting at bypass position.

The filter housings are supplied with various thread connections. Models 120 and 122 have reinforced thread connections of embedded brass.

Special versions can be supplied in accordance with the customer's specifications.

Typical special versions include a different choice of materials, type/size/location of connections, different pressure limits and/or temperature levels.

Not included in the catalogue is the product range of brass cartridge filters and special filter candles for high temperature /pressure.

For other options see also **HiFlux TP**, **HiFlux TWP**, **HiFlux PW**, **HiFlux Micro-Line 1050** and **HiFlux Micro-Line 1050 SS**.





WF Cartridge filter housing in plastic

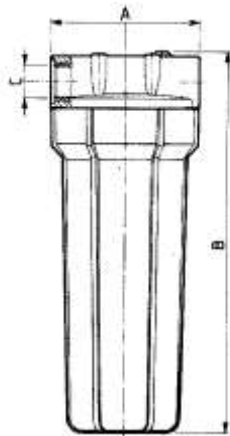

Model 122

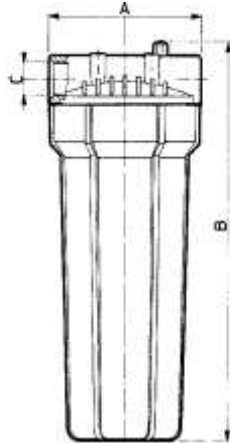

Model 202

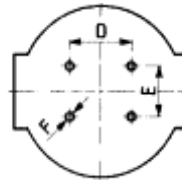

Model 122/202
Top

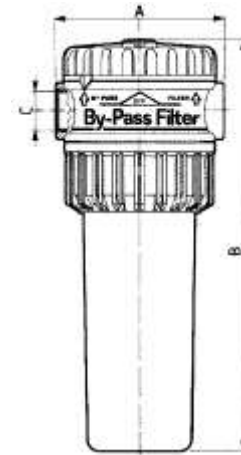

Model 120

Type	A	B	C	D	E	F	Cartridge	Capacity	Air vent.	Conne- ction	Weight
	mm	mm	mm	mm	mm	mm	D.O.E.	M ³ /h	Plug	Thread	Kg
122/5" - 1/2	123	175	1/2	44	34	3,8	1x5"	0,75	Rp1/2	Rp3/8	0,7
122/5" - 3/4	123	175	3/4	44	34	3,8	1x5"	0,75	Rp3/4	Rp1/2	0,7
122/9 3/4" - 3/4	123	302	3/4	44	34	3,8	1x9 3/4	1,5	Rp1/8	Rp3/4	1,0
122/20" - 3/4	123	567	3/4	44	34	3,8	1x20"	3,0	Rp1/8	Rp3/4	1,4
202/5" - 3/8	123	180	3/8	44	34	3,8	1x5"	0,75	Rp1/8	Rp3/8	0,7
202/5" - 1/2	123	180	1/2	44	34	3,8	1x5"	0,75	Rp1/8	Rp1/2	0,7
202/9 3/4" - 3/4	123	308	3/4	44	34	3,8	1x9 3/4	1,5	Rp1/8	Rp3/4	1,0
202/20" - 3/4	123	573	3/4	44	34	3,8	1x20"	3,0	Rp1/8	Rp3/4	1,4
120/9 3/4" - 3/4	140	339	3/4	-	-	-	1x9 3/4	1,5	Auto	Rp3/4	1,3
120/9 3/4" - 1	140	339	1	-	-	-	1x9 3/4	1,5	Auto	Rp1	1,3
120/20" - 3/4	140	615	3/4	-	-	-	1x20"	3,0	Auto	Rp3/4	2,0
120/20" - 1	140	615	1	-	-	-	1x20"	3,0	Auto	Rp1	2,0

Design pressure: 8,6 bar
 Test pressure: 15 bar
 Max. Working temperature: 40° C
 Connection: Thread: EN 10226-1
 Filter cartridges: See datasheet for filter cartridges
 Cartridge types: Cartridges with opening in both ends (D.O.E.)
 Washers: EPDM

* The capacity is based on a viscosity of 1 cSt and is not affected by cartridge type, degree of filtration in microns or dirt load