

HS-200SRT Temperature Sensor

only PT100 temperature output via 2 Pin MS Connector

Key Features

- PT100 Temperature output
- For use with data collector
- Customisable features

Industries

Building services, Pulp and Paper, Mining, Metals, Utilities, Automotive, Water, Pharmaceutical

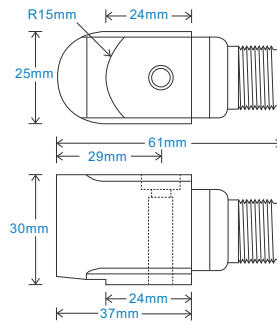

Connection Details

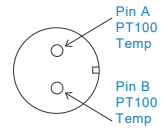

Technical Performance

Temperature Output PT100 (100 Ohms)
Isolation Base isolated

Mechanical

Case Material Stainless Steel
Mounting Torque 8Nm
Weight 200gms (nominal)
Screened Cable Assembly see: www.hansfordsensors.com for options
Connector HS-AA004 - non-booted
HS-AA053 or HS-AA054 - booted
Mounting Threads see: 'How To Order' table

Electrical

Environmental

Operating Temperature Range see: 'How To Order' table
Sealing IP68
EMC EN61326-1:2013

Applications

Fans, Motors, Pumps, Compressors, Centrifuges, Conveyors, Air Handlers, Gearboxes, Rolls, Dryers, Presses, Cooling, VAC, Spindles, Machine Tooling, Process Equipment

Vibration sensor should be firmly fixed to a flat surface (spot face surface may be needed to be produced and cable anchored to sensor body.)

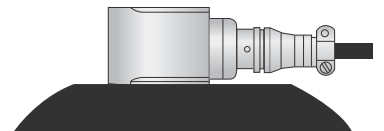

How To Order

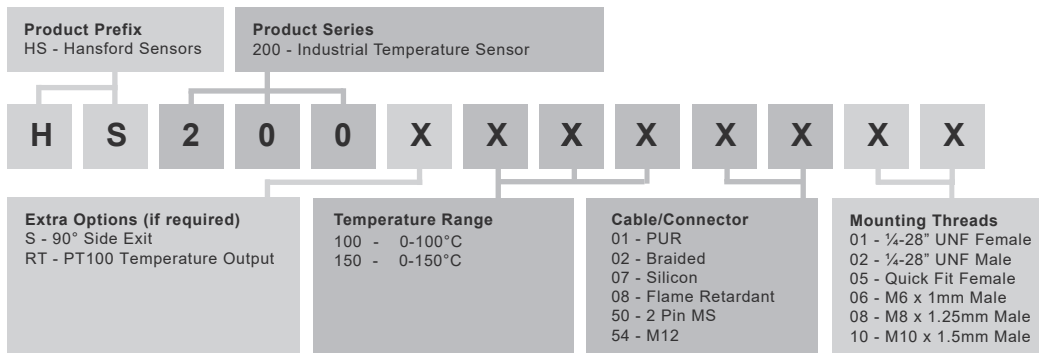

www.hansfordsensors.com
sales@hansfordsensors.com

We reserve the right to alter the specification of this product without prior notice
TS856.6

